

- 1
- 2
- 3
- 4
- 5
- 6
- 7
- 8
- 9
- 10
- 11
- 12
- 13
- 14
- 15
- 16
- 17
- 18
- 19

**MATERIAL**

Transparent sulphonic based technopolymer (PPSU). Avoid contact with alcohol and wash mixtures containing alcohol.

The window consists of a continuous series of prisms which provide a clear and immediate reading of the level of the oil contained in the reservoir.

**PACKING RING**

NBR synthetic rubber.

**MAXIMUM CONTINUOUS WORKING TEMPERATURE**

100°C.

**TECHNICAL DATA**

The tightening torque indicated in the table guarantees an optimal tightness, keeping the packing ring in the correct position.

**NOTE**

For use with other fluids with special additives, please contact ELESAs Sales Department.

**ACCESSORIES ON REQUEST**

Brass nut type GH. (see page 1574) for fitting to reservoirs with wall thickness smaller than 5 mm.



ELESAs Original design

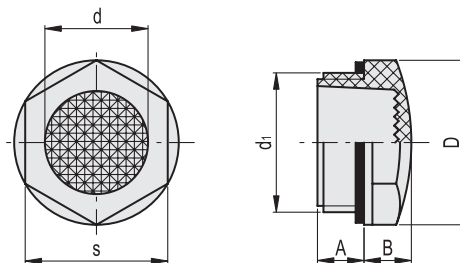

Code	Description	d1	A	B	D	d	s	Tightening torque [Nm]	⚖️
13652	HFTX.9/PR-1/4	G1/4	10	6	18	9	15	2+3	3
13672	HFTX.12/PR-3/8	G3/8	7.5	7	22	11	19	3+5	4
13692	HFTX.15/PR-1/2	G1/2	10.5	8	26	14	22	4+6	5
13722	HFTX.20/PR-3/4	G3/4	10.5	9	31.5	20	27	6+8	8
13742	HFTX.24/PR-1	G1	11	10	40	25	34	8+10	12