

Han 16B-Base Panel 2 Levers IP67

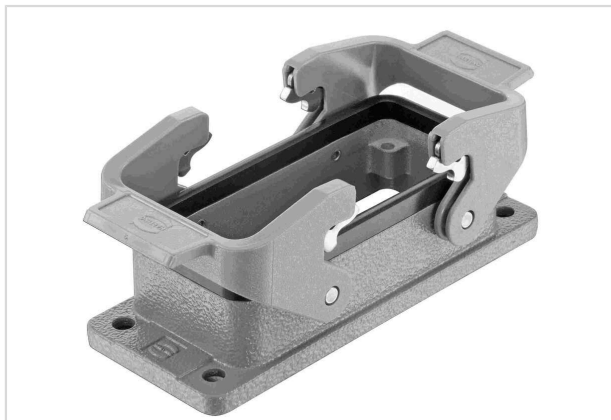

Image is for illustration purposes only. Please refer to product description.

| | |
|--------------------|---|
| Part number | 09 30 016 1301 |
| Specification | Han 16B-Base Panel 2 Levers IP67 |
| HARTING eCatalogue | https://b2b.harting.com/09300161301 |

Identification

| | |
|--------------------------|--------------------------|
| Category | Hoods / Housings |
| Series of hoods/housings | Han [®] B |
| Type of hood/housing | Bulkhead mounted housing |
| Type | Low construction |

Version

| | |
|----------------------------|---|
| Size | 16 B |
| Locking type | Double locking lever |
| Han-Easy Lock [®] | Yes |
| Field of application | Standard hoods/housings for industrial connectors |

Technical characteristics

| | |
|--|--|
| Limiting temperature | -40 ... +125 °C |
| Note on the limiting temperature | For use as a connector according to IEC 61984. |
| Mating cycles | ≥500 |
| Degree of protection acc. to IEC 60529 | IP65 IP67 |
| Type rating acc. to UL 50 / UL 50E | 4 4X 12 |

Material properties

| | |
|-------------------------|--------------------|
| Material (hood/housing) | Aluminium die-cast |
| Surface (hood/housing) | Powder-coated |



Pushing Performance
Since 1945

Material properties

| | |
|--|---|
| Colour (hood/housing) | RAL 7037 (dust grey) |
| Material (seal) | NBR |
| Material (locking) | Polycarbonate (PC) Stainless steel |
| Colour (locking) | RAL 7037 (dust grey) |
| Material flammability class acc. to UL 94 (locking levers) | V-0 |
| RoHS | compliant |
| ELV status | compliant |
| China RoHS | e |
| REACH Annex XVII substances | Not contained |
| REACH ANNEX XIV substances | Not contained |
| REACH SVHC substances | Yes |
| REACH SVHC substances | Potassium 1,1,2,2,3,3,4,4,4-nonafluorobutane-1-sulphonate |
| ECHA SCIP number | 60b1a572-bb3f-476f-9307-b7d1688bd90c |
| California Proposition 65 substances | Yes |
| California Proposition 65 substances | Nickel Naphthalene |
| Fire protection on railway vehicles | EN 45545-2 (2020-08) |
| Requirement set with Hazard Levels | R1 (HL 1-3) R7 (HL 1-3) |

Specifications and approvals

| | |
|-----------|--|
| UL / CSA | UL 1977 ECBT2.E235076 CSA-C22.2 No. 182.3 ECBT8.E235076 |
| Approvals | CE DNV GL |

Commercial data

| | |
|--------------------------------|---------------|
| Packaging size | 1 |
| Net weight | 100 g |
| Country of origin | China |
| European customs tariff number | 85389099 |
| GTIN | 5713140046221 |
| ETIM | EC000437 |



Pushing Performance
Since 1945

Commercial data

eCl@ss

27440202 Shell for industrial connectors