



Image for illustrative purpose only

Summary

[Request a quote](#)

[Catalog](#)

| | |
|------------------------------------|---|
| Nb of contacts Triax | 1 |
| Socket / Receptacle | Socket / Receptacle - Fixed Panel Front Mounted |
| Locking system | Push-pull |
| Jacket cable outside diameter [mm] | 1.00 - 10.60 mm |
| Size | 1S |
| Suggested matching part | FFA.1S.650.CLAC47 |
| Series | S - Indoor Stepped Insert |

https://www.lemo.com/int_en/solutions/originals/s-indoor-stepped-insert/ern-1s-650-cll.html

LEMO products and services are provided "as is". LEMO makes no warranties or representations with regard to LEMO product & services or use of them, express, implied or statutory, including for accuracy, completeness, or security. The user is fully responsible for his products and applications using LEMO components.

Technical details

Electrical Configuration

| | |
|----------------------------|-------------------------------|
| Nb of contacts Triax | 1 |
| Contact Termination Triax | Solder |
| Insert configuration value | 1S.650 - 1 Triax (50 Ohm) |
| Insulator | L: PEEK (UL 94 / V-0/1.5) |
| Rated current | 6 A |
| Impedance | 50 Ohm |
| OHM | 50 |
| VSWR | $1.01 + 0.17 * f/\text{GHz}$ |
| Vtest | 1200 V (AC), 1700 V (DC) |
| Contact Type | Triaxial 50 Ohm (Solder) |
| Cable type | RGT 178, RGT 174, Belden 9222 |
| Bucket Dia. | 0.8 |
| Contact Dia. | 0.9 mm (0.034in) |

Form & Material

| | |
|------------------------|---|
| Shell style / Model id | ERN - Fixed receptacle, nut fixing, with grounding tab |
| Socket / Receptacle | Fixed Panel Front Mounted |
| Housing material | Brass (chrome plated [SAE AMS 2460]) shell and collet nut, nickel plated [SAE AMS QQ N 290] brass latch sleeve and mid pieces |
| Locking system | Push-pull |
| Keying | Circular, female |
| Colour | Grey |
| Weight | 8.73 g |

https://www.lemo.com/int_en/solutions/originals/s-indoor-stepped-insert/ern-1s-650-cll.html

LEMO products and services are provided "as is". LEMO makes no warranties or representations with regard to LEMO product & services or use of them, express, implied or statutory, including for accuracy, completeness, or security. The user is fully responsible for his products and applications using LEMO components.

Environment

| | |
|-----------------------------------|---|
| Technical domain | Audio Video, Energy and Industrial, Semiconductor, Test and Measurement |
| Environmental sealing (IP rating) | IP50 |
| Endurance | 5000 mating cycles |
| Temperature range | -55°C / +250°C |
| Climatical Category | 50/175/21 |
| Humidity (max) | <=95% [at 60 deg C /140 F] |
| Shielding (min) | 75 dB (10 MHz) |
| Shielding (min) | 40 dB (1 GHz) |
| Shock Resistance | 100 g [6 ms] |
| Vibration | 15 g [10 Hz - 2000 Hz] |
| Salt Spray Corrosion | >1000 hr |

Cable fixation

| | |
|------------------------------------|-----------------|
| Jacket cable outside diameter [mm] | 1.00 - 10.60 mm |
|------------------------------------|-----------------|

Drawings

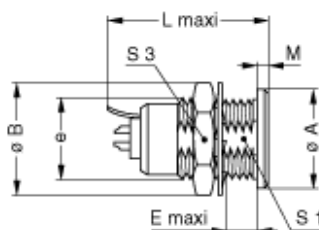

Recommended By Lemo

Accessories

Compatible cap

[BRE.1S.200.NAS](#)

https://www.lemo.com/int_en/solutions/originals/s-indoor-stepped-insert/ern-1s-650-cll.html

LEMO products and services are provided "as is". LEMO makes no warranties or representations with regard to LEMO product & services or use of them, express, implied or statutory, including for accuracy, completeness, or security. The user is fully responsible for his products and applications using LEMO components.