



*Image for illustrative purpose only*

## Summary

[Request a quote](#)

[Catalog](#)

Nb of contacts Triax	1
Socket / Receptacle	Socket / Receptacle - Fixed Panel Front Mounted
Locking system	Push-pull
Jacket cable outside diameter [mm]	1.00 - 8.30 mm
Size	0S
Suggested matching part	<a href="#">FFA.0S.650.CTLC42Z</a>
Series	S - Indoor Stepped Insert

[https://www.lemo.com/int\\_en/solutions/originals/s-indoor-stepped-insert/ern-0s-650-cta.html](https://www.lemo.com/int_en/solutions/originals/s-indoor-stepped-insert/ern-0s-650-cta.html)

LEMO products and services are provided "as is". LEMO makes no warranties or representations with regard to LEMO product & services or use of them, express, implied or statutory, including for accuracy, completeness, or security. The user is fully responsible for his products and applications using LEMO components.

# Technical details

## Electrical Configuration

Nb of contacts Triax	1
Contact Termination Triax	Solder
Insert configuration value	0S.650 - 1 Triax (50 Ohm)
Insulator	T: PTFE
Rated current	6 A
Impedance	50 Ohm
OHM	50
VSWR	$1.03 + 0.34 * f/\text{GHz}$
Vtest	1200 V (AC), 1700 V (DC)
Contact Type	Triaxial 50 Ohm (Solder)
Cable type	RGT 178, RGT 174
Bucket Dia.	0.8
Contact Dia.	0.9 mm (0.035" in)

## Form & Material

Shell style / Model id	ERN - Fixed receptacle, nut fixing, with grounding tab
Socket / Receptacle	Fixed Panel Front Mounted
Housing material	Brass (chrome plated [SAE AMS 2460]) shell and collet nut, nickel plated [SAE AMS QQ N 290] brass latch sleeve and mid pieces
Locking system	Push-pull
Keying	Circular, male
Colour	Grey
Weight	4.44 g

[https://www.lemo.com/int\\_en/solutions/originals/s-indoor-stepped-insert/ern-0s-650-cta.html](https://www.lemo.com/int_en/solutions/originals/s-indoor-stepped-insert/ern-0s-650-cta.html)

LEMO products and services are provided "as is". LEMO makes no warranties or representations with regard to LEMO product & services or use of them, express, implied or statutory, including for accuracy, completeness, or security. The user is fully responsible for his products and applications using LEMO components.

## Environment

Technical domain	Audio Video, Energy and Industrial, Semiconductor, Test and Measurement
Environmental sealing (IP rating)	IP50
Endurance	5000 mating cycles
Temperature range	-55°C / +250°C
Climatical Category	50/175/21
Humidity (max)	<=95% [at 60 deg C /140 F]
Shielding (min)	75 dB (10 MHz)
Shielding (min)	40 dB (1 GHz)
Shock Resistance	100 g [ 6 ms]
Vibration	15 g [10 Hz - 2000 Hz]
Salt Spray Corrosion	>1000 hr

## Cable fixation

Jacket cable outside diameter [mm]	1.00 - 8.30 mm
------------------------------------	----------------

## Drawings

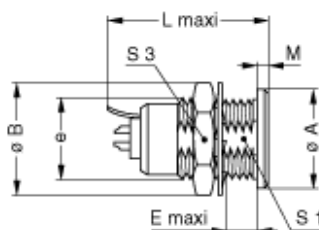

## Recommended By Lemo

### Accessories

Compatible cap

[BRE.0S.200.NAS](#)

[https://www.lemo.com/int\\_en/solutions/originals/s-indoor-stepped-insert/ern-0s-650-cta.html](https://www.lemo.com/int_en/solutions/originals/s-indoor-stepped-insert/ern-0s-650-cta.html)

LEMO products and services are provided "as is". LEMO makes no warranties or representations with regard to LEMO product & services or use of them, express, implied or statutory, including for accuracy, completeness, or security. The user is fully responsible for his products and applications using LEMO components.