



Image for illustrative purpose only

Summary

[Request a quote](#)

[Catalog](#)

Nb of contacts Triax	1
Socket / Receptacle	Socket / Receptacle - Fixed Panel Front Mounted
Locking system	Push-pull
Jacket cable outside diameter [mm]	1.00 - 13.60 mm
Size	2S
Suggested matching part	FFA.2S.650.CTAC32Z
Series	S - Indoor Stepped Insert

https://www.lemo.com/int_en/solutions/originals/s-indoor-stepped-insert/ern-2s-650-ctl.html

LEMO products and services are provided "as is". LEMO makes no warranties or representations with regard to LEMO product & services or use of them, express, implied or statutory, including for accuracy, completeness, or security. The user is fully responsible for his products and applications using LEMO components.

Technical details

Electrical Configuration

Nb of contacts Triax	1
Contact Termination Triax	Solder
Insert configuration value	2S.650 - 1 Triax (50 Ohm)
Insulator	T: PTFE
Rated current	12 A
Impedance	50 Ohm
OHM	50
VSWR	1.01 + 0.3 * f/GHz
Vtest	1200 V (AC), 1700 V (DC)
Contact Type	Triaxial 50 Ohm (Solder)
Cable type	RGT 174,Belden 9222,8215,8232A,HF-2426,Triax 8 Nokia,375 029 LEDE
Bucket Dia.	1.4
Contact Dia.	1.6 mm (0.063in)

Form & Material

Shell style / Model id	ERN - Fixed receptacle, nut fixing, with grounding tab
Socket / Receptacle	Fixed Panel Front Mounted
Housing material	Brass (chrome plated [SAE AMS 2460]) shell and collet nut, nickel plated [SAE AMS QQ N 290] brass latch sleeve and mid pieces
Locking system	Push-pull
Keying	Circular, female
Colour	Grey
Weight	14.83 g

https://www.lemo.com/int_en/solutions/originals/s-indoor-stepped-insert/ern-2s-650-ctl.html

LEMO products and services are provided "as is". LEMO makes no warranties or representations with regard to LEMO product & services or use of them, express, implied or statutory, including for accuracy, completeness, or security. The user is fully responsible for his products and applications using LEMO components.

Environment

Technical domain	Audio Video, Energy and Industrial, Semiconductor, Test and Measurement
Environmental sealing (IP rating)	IP50
Endurance	5000 mating cycles
Temperature range	-55°C / +250°C
Climatical Category	50/175/21
Humidity (max)	<=95% [at 60 deg C /140 F]
Shielding (min)	75 dB (10 MHz)
Shielding (min)	40 dB (1 GHz)
Shock Resistance	100 g [6 ms]
Vibration	15 g [10 Hz - 2000 Hz]
Salt Spray Corrosion	>1000 hr

Cable fixation

Jacket cable outside diameter [mm]	1.00 - 13.60 mm
------------------------------------	-----------------

Drawings

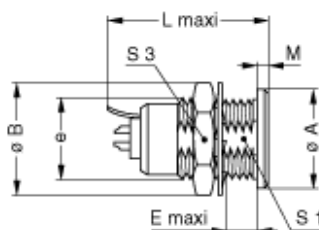

Recommended By Lemo

Accessories

Compatible cap

[BRE.2S.200.NAS](#)

https://www.lemo.com/int_en/solutions/originals/s-indoor-stepped-insert/ern-2s-650-ctl.html

LEMO products and services are provided "as is". LEMO makes no warranties or representations with regard to LEMO product & services or use of them, express, implied or statutory, including for accuracy, completeness, or security. The user is fully responsible for his products and applications using LEMO components.