



Image for illustrative purpose only

Summary

[Request a quote](#)

[Catalog](#)

| | |
|------------------------------------|---------------------------------|
| Number of contacts Low Voltage | 8 |
| Wire Size/AWG | 26 - 22 |
| Gender | Reverse Gender |
| Socket / Receptacle | Socket / Receptacle - Free |
| Locking system | Ratchet |
| Jacket cable outside diameter [mm] | 4.85 - 9.70 mm |
| Size | 1M |
| Suggested matching part | FMS.1M.308.XLMT |
| Series | M - Rugged Ratchet coupling |

https://www.lemo.com/int_en/solutions/optima/m-ratchet-coupling/pms-1m-308-xlct.html

LEMO products and services are provided "as is". LEMO makes no warranties or representations with regard to LEMO product & services or use of them, express, implied or statutory, including for accuracy, completeness, or security. The user is fully responsible for his products and applications using LEMO components.

Technical details

Electrical Configuration

| | |
|---------------------------------------|-------------------------------|
| Contact Termination Low voltage | Crimp |
| R (max) | 6.1 mOhm |
| Insert configuration value | 1M.308 - 8 Low Voltage |
| Insulator | L: PEEK |
| Rated current | 5 A |
| Test voltage (kV rms) Contact-contact | 1.3 |
| Test voltage (kV rms) Contact-shell | 1.1 |
| Contact retention | 22 N |
| Contact Type | Crimp |
| Max. Conductor | 0.34 mm ² (AWG 22) |
| Min. Conductor | 0.14 mm ² (AWG 26) |
| Bucket Dia. | 0.8 mm (0.031in) |
| Contact Dia. | 0.7 mm (0.028in) |
| Number of contacts Low Voltage | 8 |
| Wire Size/AWG | 26 - 22 |
| Gender | Reverse Gender |

Form & Material

| | |
|------------------------|---|
| Shell style / Model id | PM - Free receptacle with knurled grip and mold stop |
| Socket / Receptacle | Free |
| Housing material | Aluminium (nickel plated [SAE AMS QQ N 290], anthracite color) shell and nut, other pieces bronze/brass |
| Locking system | Ratchet |
| Keying | S: 3 keys (beta=155, gamma=50, plug: female contacts, receptacle: male contacts) |
| Colour | Grey |
| Weight | 8.25 g |

https://www.lemo.com/int_en/solutions/optima/m-ratchet-coupling/pms-1m-308-xlct.html

LEMO products and services are provided "as is". LEMO makes no warranties or representations with regard to LEMO product & services or use of them, express, implied or statutory, including for accuracy, completeness, or security. The user is fully responsible for his products and applications using LEMO components.

Environment

| | |
|-----------------------------------|--|
| Technical domain | Motorsport, Security and Defence, Transportation, Aerospace and UAV |
| Environmental sealing (IP rating) | IP68 |
| Endurance | 3000 mating cycles |
| Temperature range | -20°C / +200°C |
| EMI Shielding EIA 364-66A | >= 80 dB (1 GHz), >=70 dB (3 GHz), >= 58 dB (6 GHz), >= 40 dB (10 GHz) |
| Gunfire vibration | 25 Hz - 2000 Hz, 3 axis (Apache helicopter) |
| Humidity (max) | 21 days at 95% |
| Lighting strike EIA 364-76 | 10K amps - 6 times |
| Shock Resistance | 300 g [3 ms] |
| Thermal shock | 5 cycles: -65°C to +150°C |
| Vibration-Random | 37.8 g rms - 3 axes, 4 hr amb [50 Hz - 2000 Hz] |
| Vibration-Sine | 30 g, 3 axes, 12 hr [10 Hz - 2000 Hz] |
| Salt Spray Corrosion | max. 48 hr |

Cable fixation

| | |
|------------------------------------|----------------------|
| Cable termination protection | For overmolding |
| Fixation type | T type cable adapter |
| Jacket cable outside diameter [mm] | 4.85 - 9.70 mm |

Drawings

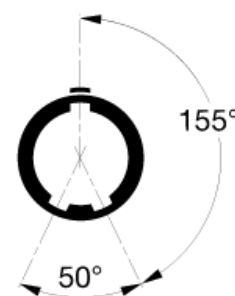
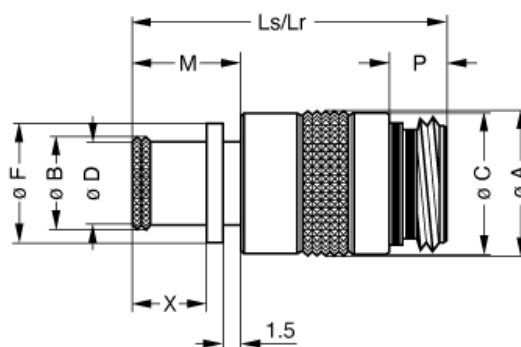

Dimensions

| | A | B | C | D | F | Ls | Lr | M | P | X |
|-----|------|------|------|------|------|------|------|------|------|------|
| mm. | 14.6 | 10.5 | 14.2 | 9.7 | 12.4 | 28.6 | 28.6 | 9.7 | 5.3 | 6.7 |
| in. | 0.57 | 0.41 | 0.56 | 0.38 | 0.49 | 1.13 | 1.13 | 0.38 | 0.21 | 0.26 |

https://www.lemo.com/int_en/solutions/optima/m-ratchet-coupling/pms-1m-308-xlct.html

LEMO products and services are provided "as is". LEMO makes no warranties or representations with regard to LEMO product & services or use of them, express, implied or statutory, including for accuracy, completeness, or security. The user is fully responsible for his products and applications using LEMO components.

Recommended By Lemo

Accessories

| | |
|---------------------|--------------------------------|
| Replacement contact | FGN.0M.555.ZZC |
|---------------------|--------------------------------|

| | |
|----------------|--------------------------------|
| Compatible cap | BMF.1M.200.XAZ |
|----------------|--------------------------------|

Tools

| | |
|-------------|---------------------------------|
| Positionner | DCE.91.070.5MVC |
|-------------|---------------------------------|

| | |
|-----------------|--------------------------------|
| Extraction tool | DCF.93.070.4LT |
|-----------------|--------------------------------|

| | |
|------------|------------------------------|
| Crimp tool | DPC.91.701.V |
|------------|------------------------------|

https://www.lemo.com/int_en/solutions/optima/m-ratchet-coupling/pms-1m-308-xlct.html

LEMO products and services are provided "as is". LEMO makes no warranties or representations with regard to LEMO product & services or use of them, express, implied or statutory, including for accuracy, completeness, or security. The user is fully responsible for his products and applications using LEMO components.