



Image for illustrative purpose only

## Summary

[Request a quote](#)

[Catalog](#)

Number of contacts Low Voltage	4
Wire Size/AWG	24 - 20
Gender	Standard
Socket / Receptacle	Socket / Receptacle - Fixed Panel Front Mounted
Locking system	Push-pull
Jacket cable outside diameter [mm]	1.00 - 12.60 mm
Size	1P
Series	REDEL P - Push-Pull

[https://www.lemo.com/int\\_en/solutions/redel/redel-p-push-pull/pka-m0-4sl-mz.html](https://www.lemo.com/int_en/solutions/redel/redel-p-push-pull/pka-m0-4sl-mz.html)

LEMO products and services are provided "as is". LEMO makes no warranties or representations with regard to LEMO product & services or use of them, express, implied or statutory, including for accuracy, completeness, or security. The user is fully responsible for his products and applications using LEMO components.

# Technical details

## Electrical Configuration

Contact Termination Low voltage	Crimp
R (max)	4.5 mOhm
Insert configuration value	1P.M04 - 4 Low Voltage
Insulator	L: PEEK (UL 94 / V-0/1.5)
Rated current	8 A
Test voltage (kV rms) Contact-contact	1.2
Contact retention	24 N
Contact Type	Crimp
Max. Conductor	0.25 mm <sup>2</sup> (AWG 24)
Min. Conductor	0.5 mm <sup>2</sup> (AWG 20)
Air clearance	1.52 mm
Creepage distance	1.52 mm
Bucket Dia.	1.1
Contact Dia.	0.9 mm (0.0354in)
Number of contacts Low Voltage	4
Wire Size/AWG	24 - 20
Gender	Standard

## Form & Material

Shell style / Model id	PK - Fixed receptacle without hexagonal nut
Socket / Receptacle	Fixed Panel Front Mounted
Housing material	PEI (Polyetherimide), gray
Locking system	Push-pull
Keying	A: 2 keys (alpha=40, Plug: male contacts, Receptacle: female contacts)
Variant	without front nut
Weight	5.89 g

[https://www.lemo.com/int\\_en/solutions/redel/redel-p-push-pull/pka-m0-4sl-mz.html](https://www.lemo.com/int_en/solutions/redel/redel-p-push-pull/pka-m0-4sl-mz.html)

LEMO products and services are provided "as is". LEMO makes no warranties or representations with regard to LEMO product & services or use of them, express, implied or statutory, including for accuracy, completeness, or security. The user is fully responsible for his products and applications using LEMO components.

## Environment

Technical domain	Energy and Industrial, Medical, Test and Measurement, Transportation, Aerospace and UAV
Environmental sealing (IP rating)	IP50
Endurance	> 5000 mating cycles
Temperature range	-50°C / +170°C
F ret (max)	150 N
F ret (min)	50 N
Steam sterilization	Fully sterilizable (Steam, Gamma, ETO) following our protocols and tests in line with ISO 11134 and IEC 60601-1 standards. For more details on sterilization methods and cycles, please contact us.

## Cable fixation

Cable termination protection	For cable bend relief
Fixation type	Cable collet
Jacket cable outside diameter [mm]	1.00 - 12.60 mm

## Drawings

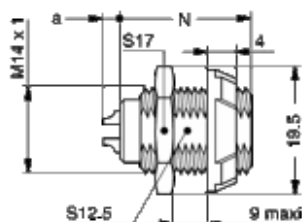

## Dimensions

	<b>A</b>	<b>a</b>	<b>N</b>
mm.	19.5	0-4.5	20.5-22.2
in.	0.77		

[https://www.lemo.com/int\\_en/solutions/redel/redel-p-push-pull/pka-m0-4sl-mz.html](https://www.lemo.com/int_en/solutions/redel/redel-p-push-pull/pka-m0-4sl-mz.html)

LEMO products and services are provided "as is". LEMO makes no warranties or representations with regard to LEMO product & services or use of them, express, implied or statutory, including for accuracy, completeness, or security. The user is fully responsible for his products and applications using LEMO components.

# Recommended By Lemo

## Accessories

---

Replacement contact [EGG.0B.664.ZZM](#)

---

Compatible cap [PBG.200.BMV](#)

## Tools

---

Spanner [POB.186.GN](#)

---

Positionner [DCE.91.090.BVM](#)

---

Extraction tool [DCC.09.05B.LAG](#)





---

Crimp tool [DPC.91.701.V](#)

[https://www.lemo.com/int\\_en/solutions/redel/redel-p-push-pull/pka-m0-4sl-mz.html](https://www.lemo.com/int_en/solutions/redel/redel-p-push-pull/pka-m0-4sl-mz.html)

LEMO products and services are provided "as is". LEMO makes no warranties or representations with regard to LEMO product & services or use of them, express, implied or statutory, including for accuracy, completeness, or security. The user is fully responsible for his products and applications using LEMO components.

# Cables

Cable PartNumber	Material	Colour	Cable image
CMN.04.T20.053PGZE		grey	
CMN.04.T20.053PNZE			
CMN.04.T20.053QGZE	TPR (medical)	Grey	
CMN.04.T22.047QGC	TPR	Grey	
CMN.04.T22.048QGZE	TPR (medical)	Grey	
CMN.04.T28.031PGCE	PVC	GREY	
CMN.04.T28.031PGZE		grey	
CMN.04.T28.031PNCE	PVC	Black	
CMN.04.T28.031PNZE			
CMN.04.T28.031QGC	TPR	Grey	
140240	PVC	Black	
140250	PVC	Grey	
240500	PVC	Grey	
240750	PVC	Grey	
40080	PVC	Black	
40086	PVC	Blue	
40140	PVC	Black	
40240	PTFE	White	
40260	PVC	Black	
4041	PVC	Grey	
4050	PVC	Black	
4080	PVC	Grey	
417920	PVC	Grey	
4220	PVC	Black	
4221	PVC	Black	
4260	PTFE	White	
4280	PVC	Black	
80080	PVC	Grey	
80082	PVC	Red	
80084	PVC	Black	
CTR.75.030.121870G	PVC	Grey	

[https://www.lemo.com/int\\_en/solutions/redel/redel-p-push-pull/pka-m0-4sl-mz.html](https://www.lemo.com/int_en/solutions/redel/redel-p-push-pull/pka-m0-4sl-mz.html)

LEMO products and services are provided "as is". LEMO makes no warranties or representations with regard to LEMO product & services or use of them, express, implied or statutory, including for accuracy, completeness, or security. The user is fully responsible for his products and applications using LEMO components.