

# 11.5kW 3-Phase Basic PDU - 45 208-240V Outlets (36 C13, 9 C19), IEC 309 16/20A Red 360-415V Input, 6 ft. Cord, 70 in. 0U

MODEL NUMBER: PDU3XV6G20

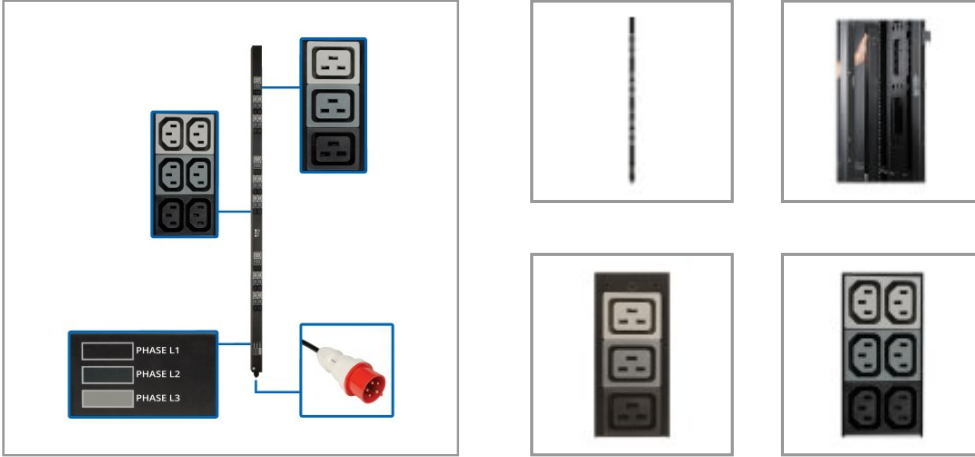

Delivers 208V-240V single-phase AC power to multiple loads from a utility outlet, generator or UPS system in a data center or network closet.

## Features

### 3-Phase 360-415V input / 208V-240V output PDU Distributes Network-Grade Power to Multiple Loads

This basic rack PDU (rPDU) is an ideal no-frills unit for networking, telecom, security, audio/video and sound reinforcement applications. Recommended for small to mid-sized data centers, computer rooms and network closets, the PDU3XV6G20 features 36 C13 and six C19 (208-240V) outlets in three single-phase output load banks for connecting equipment. A six-foot (1.8-meter) cord with IEC 309 16/20A Red 360-415V (3P+N+E) 3-phase input plug connects to your facility's AC power source, generator or protected UPS system to distribute power to connected loads.

### Easy to Install Vertically in an EIA-Standard 19 in. Rack

The 70-inch 0U PDU's all-metal housing mounts vertically using the pre-installed toolless mounting buttons or the included brackets. Spare buttons are also included. Use the included PDUMVROTATEBRKT kit to install the PDU with outlets facing the rear for better airflow or equipment access. Cable retention brackets keep power cords organized and your rack free of clutter. The PDU's switchless design helps prevent an accidental shutdown, which could lead to costly downtime.

## Specifications

OVERVIEW	
UPC Code	037332255679
PDU Type	Basic
INPUT	
Input Phase	3-Phase
PDU Input Voltage	360; 380; 400; 415

## Highlights

- Ideal no-frills PDU for telecom, security, audio/video and other network applications
- 36 C13 and 6 C19 single-phase outlets distribute AC power to connected equipment
- Switchless design helps prevent accidental shutdowns that can lead to costly downtime
- 6 ft. power cord with IEC 309 16/20A Red 3-phase input connects to AC source

## Applications

Deliver network-grade power to high-density equipment in networking, telecom, security, audio/video and sound reinforcement applications

## Package Includes

- PDU3XV6G20 11.5kW 208V-240V 3-Phase Basic PDU
- Cable retention brackets with installation hardware
- Rack-mounting hardware
- Owner's manual



Powering Business Worldwide

TRIPP LITE  
SERIES

Recommended Electrical Service	Three-phase 16A 360-415V service
Maximum Input Amps	16
Maximum Input Amps Details	Agency de-rated to 16A continuous
PDU Plug Type	IEC-60309 16/20A RED (3P+N+E)
Input Cord Length (ft.)	6
Input Cord Length (m)	1.83
<b>OUTPUT</b>	
Output Capacity (kW)	11.5
Output Capacity Details	11.5kW (415/240V), 11.1kW (400/230V), 10.5kW (380/220V), 10kW (360/208V) total capacity; 16A max per output phase (L1-L2, L2-L3, L3-L1); 16A max per C19 outlet; 12A max (10A CE) per C13 outlet
Frequency Compatibility	50 / 60 Hz
Output Receptacles	(36) C13; (9) C19
Output Nominal Voltage	208-240V
<b>SURGE / NOISE SUPPRESSION</b>	
Automatic Shut-Off	No
<b>PHYSICAL</b>	
Material of Construction	Metal
Rack Height	0U
Form Factors Supported	Vertical rackmount installation supported with included mounting brackets; supports toolless mounting in button-mount compatible racks
PDU Form Factor	Vertical (0U)
Shipping Dimensions (hwd / in.)	6.00 x 6.50 x 76.00
Shipping Weight (kg)	6.62
Unit Dimensions (hwd / in.)	70.000 x 2.200 x 1.930
Unit Dimensions (hwd / cm)	177.8 x 5.6 x 4.9
Unit Weight (lbs.)	9.00
Unit Weight (kg)	4.08
<b>ENVIRONMENTAL</b>	
Operating Temperature Range	32° to 104°F (0° to 40°C)
Storage Temperature Range	-22° to 122°F (-30° to 50°C)
Relative Humidity	5% to 95% non-condensing
Operating Elevation	0-10000 ft. (0-3000 m)
<b>STANDARDS &amp; COMPLIANCE</b>	
Product Certifications	CAN/CSA C22.2; UL 60950-1



Powering Business Worldwide

TRIPP LITE  
SERIES

Product Compliance	CE (Europe); FCC Part 15 Class A (USA); RoHS; UKCA
<b>WARRANTY &amp; SUPPORT</b>	
Product Warranty Period (Worldwide)	2-year limited warranty

1000 Eaton Boulevard  
Cleveland, OH 44122  
United States  
<https://tripplite.eaton.com>

© 2025 Eaton. All Rights Reserved.  
Eaton is a registered trademark. All other trademarks  
are the property of their respective owners.